

Control panel part names

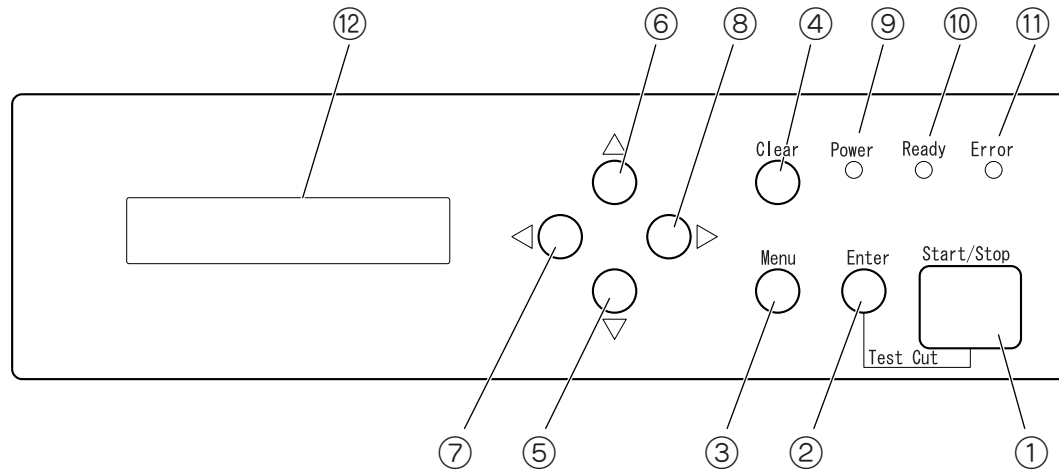

① START/STOP switch

② ENTER switch

③ MENU switch

④ CLEAR switch

⑤ DOWN switch

⑥ UP switch

⑦ LEFT switch

⑧ RIGHT switch

⑨ POWER LED lamp

⑩ READY LED lamp

⑪ ERROR LED lamp

⑫ LCD (20 digits x 2 lines)

CUTTING JOB SEQUENCE

Operate the auto cutter in the following sequence.

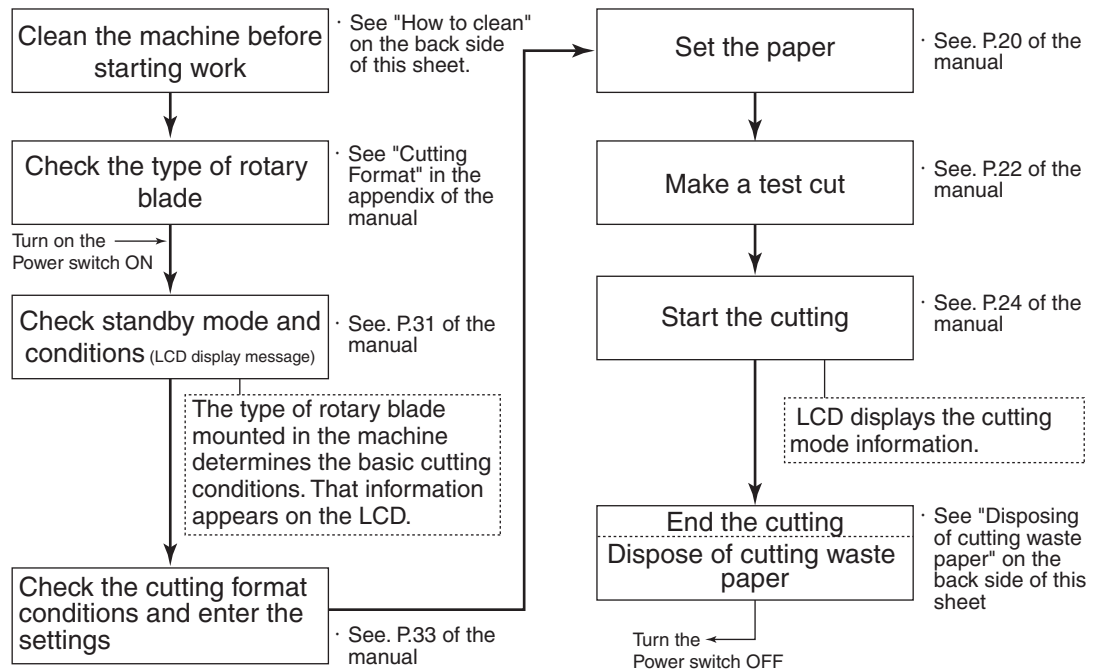

ERROR MESSAGE LIST

When an error occurs in the machine, the following error code and message or troubleshooting methods appear on the LCD. When an error occurs, turn the power off and troubleshoot the problem. (See P. 28 of the instruction manual for more information.)

Code	Error messages	Code	Error messages
E11	Cannot detect cutting marks	D21	Paper is jammed
K11	Front cover is open	D22	Or machine is broken
K21	Rotary blade not installed	D11	Feed tray rise error
K31	Top cover is open	S31	Rotary blade is not mounted correctly
J11.12	Paper jam (paper conveyor section)	S11	Machine is broken
J21.22		S12	
J31.32		S13	
J51.52	S21		
E21	Cutting paper format does not match size of paper to cut	S21	Machine is broken
E22		S31	

■ DAILY CARE OF THE MACHINE (CLEANING THE RETARD PADS - PAPER FEED ROLLER - SENSORS)

Clean the machine daily to keep it in good condition. Be sure to clean the "Retard Pads - Paper Feed Roller - Sensor" at the following maintenance periods.

Cleaning Point	Cleaning Cycle
Retard pads	Once every 500 sheets
Paper feed roller	Once every 1,000 sheets
Sensors	Once a week

■ PAPER CONVEYOR (CLEANING THE RETARD PADS - PAPER FEED ROLLER - SENSORS)

Always turn the power switch off when cleaning the various parts of the machine.

■ How to clean the paper feed roller (Clean once every 1,000 sheets)

1. Lift the top cover release lever and open the top cover.

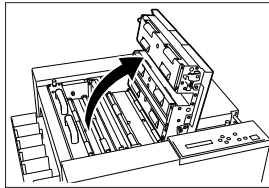

2. Clean the rubber roller (black), the plastic roller (white) on the top cover side, and the upper/lower eject rollers behind the rotary blade with a rag soaked in non-hydrated alcohol.

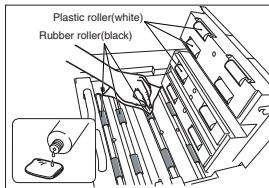

■ How to clean the sensors (Clean once a week)

1. Using a cotton swab or similar item, gently wipe away dirt from the lens surface of the sensors (top cover side) as shown in the drawing.

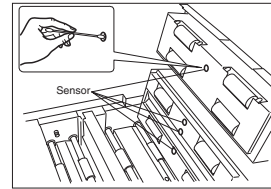

Note
Cutting waste, grime or dirt adhering to the sensor lens, will cause a drop in sensor sensitivity or will be mistakenly detected as a paper jam.

■ How to clean the retard pads (Clean once every 500 sheets.)

1. Retard pads are important because they prevent more than 1 sheet a time from being fed. If paper residue or powder sticks to these pads, the paper feed will function poorly. Clean the retard pads every time 500 sheets have passed through them.

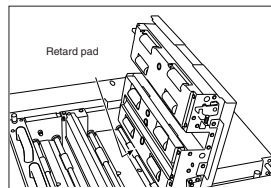

[Reference]

Clean the retard pads by passing 2 sheets of fine-grade white paper between them.

■ Cleaning the machine exterior

Wipe off the paper feed tray and machine exterior with a cloth dipped in water and wrung out. Finally wipe with a dry, clean cloth.

■ Disposing of cutting waste paper

Always dispose of the cutting waste after finishing work each day. On days with a heavy volume of paper cutting work, check the amount of cutting waste that has piled up inside the hopper by looking in its inspection window at regular intervals. (The amount of cutting waste will vary depending on the rotary blade and the cutting format.)

1. Turn off the power (O side of switch).
2. Check the amount of cutting waste in the inspection window.
3. Grip the hand-hold on the front cover and open the front cover outwards.
4. Remove the cutting waste hopper and throw away the cutting waste inside it.
5. Put the cutting waste hopper back in the machine and shut the front cover.

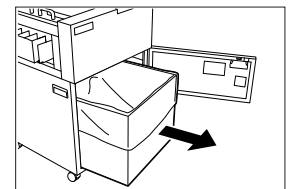
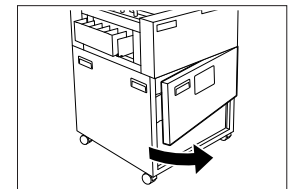
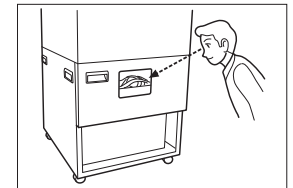
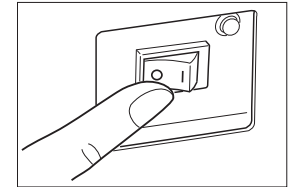

Caution

If cutting waste piles up in the hopper, cutting performance will drop, paper jams and cutting defects might occur. In worst cases the rotary blade might be damaged. Throw away the cutting waste at least once a day.

[Reference]

The hopper cutting waste bag is a disposable product. To order more of these bags contact your dealer.